

ASSEMBLY / PARTS LIST (B.O.M.)

Series: 3000

Type: OXOL Configuration with Screen

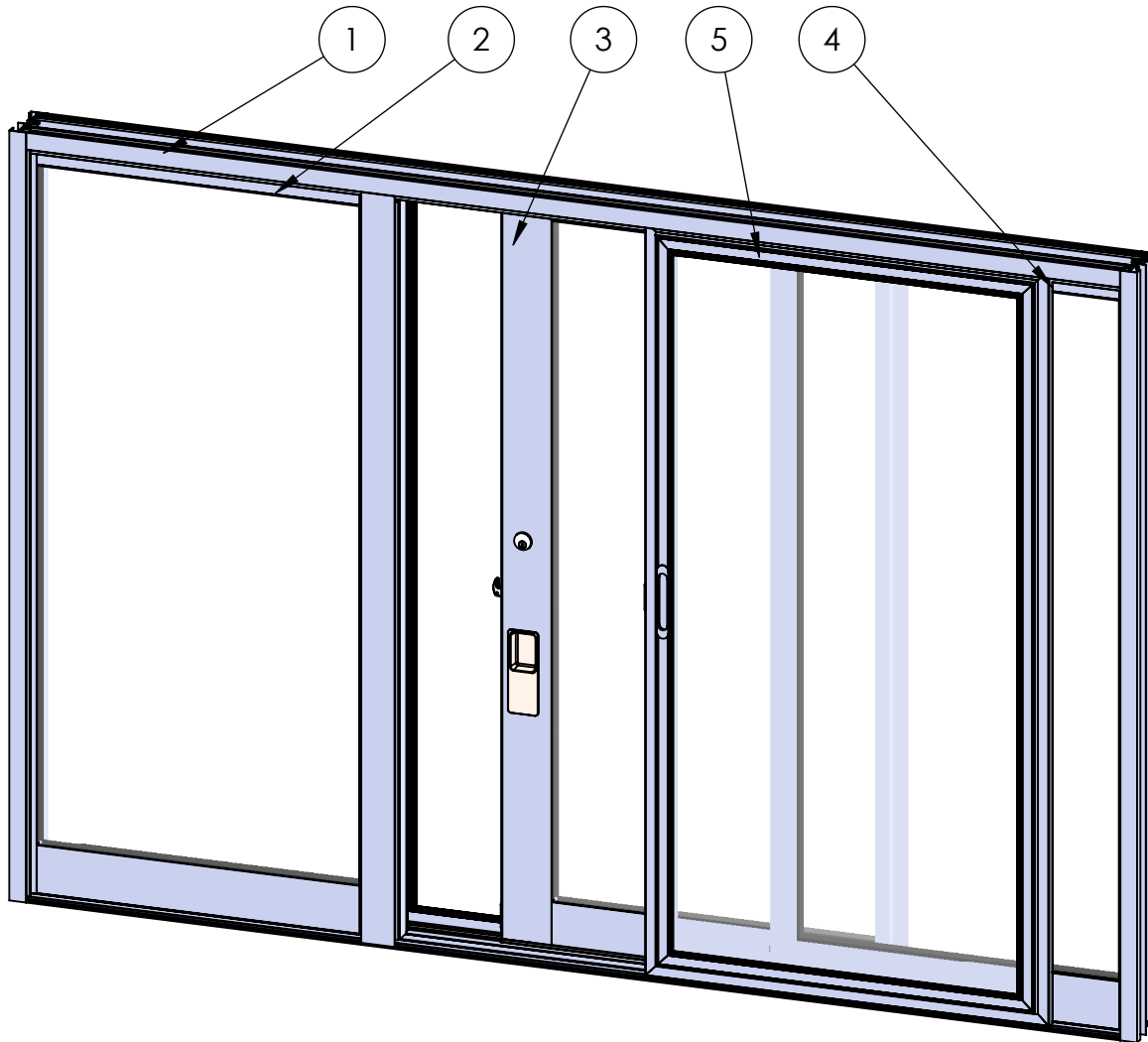

TABLE OF CONTENTS

ITEM NO.	DESCRIPTION	PAGE(S)
1	Frame	2-3
2	O Panel Fixed	4
3	X Panel	5-6
4	O Panel	7
5	Screen	8

Description

Table of Contents

File Name

Series 3000 OXOL
Assembly

REV
H

Released 12/3/2025

SHEET 1 OF 8

PROPRIETARY AND CONFIDENTIAL

THE INFORMATION CONTAINED IN THIS DRAWING IS THE SOLE PROPERTY OF FLEETWOOD WINDOWS & DOORS.
ANY REPRODUCTION IN PART OR AS A WHOLE WITHOUT THE WRITTEN PERMISSION OF FLEETWOOD WINDOWS & DOORS IS PROHIBITED.

ASSEMBLY / PARTS LIST (B.O.M.)

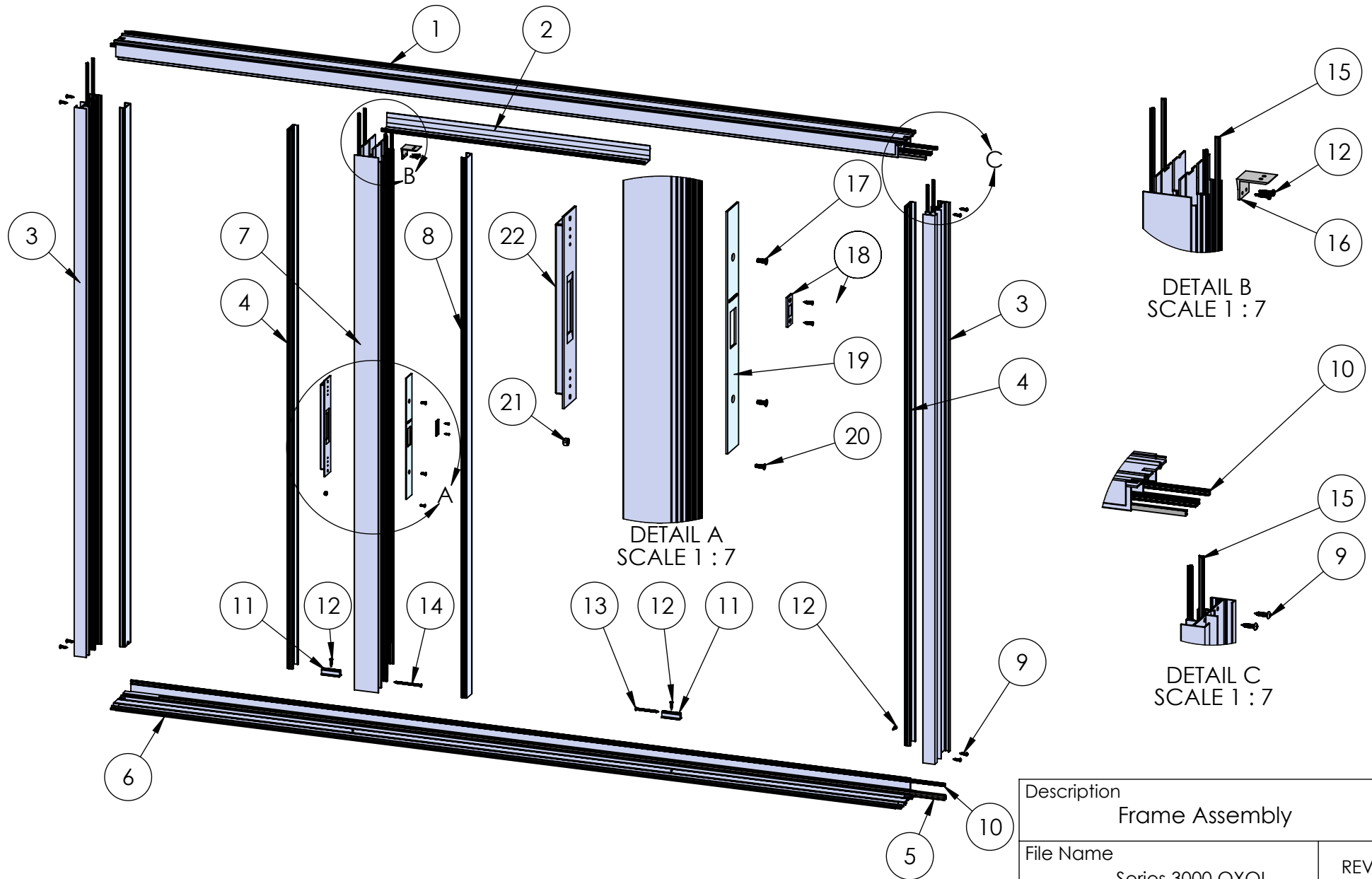

PROPRIETARY AND CONFIDENTIAL

THE INFORMATION CONTAINED IN THIS DRAWING IS THE SOLE PROPERTY OF FLEETWOOD WINDOWS & DOORS.
ANY REPRODUCTION IN PART OR AS A WHOLE WITHOUT THE WRITTEN PERMISSION OF FLEETWOOD WINDOWS & DOORS IS PROHIBITED.

Description Frame Assembly		
File Name Series 3000 OXOL Assembly		REV H
Released	12/3/2025	SHEET 2 OF 8

ASSEMBLY / PARTS LIST (B.O.M.)

EXTRUSIONS

ITEM NO.	PART NUMBER	DESCRIPTION	QTY.
1	3017, 3095	Head (Block, Nail-fin)	1
2	3011	Head Filler	1
3	3001, 3012	Jamb (Block, Nail-fin)	2
4	3102	Interior Jamb Filler	3
5	FW1020	Stainless Steel Track	1
6	3002, 3003, 3038	Sill (1.25", 1.88", 3")	1
7	3052	False Jamb	1
8	3016	Exterior Jamb Filler	1

HARDWARE

ITEM NO.	PART NUMBER	DESCRIPTION	QTY.
9	20347	#10 PHP - A, 3/4", SS, Clear	8
10	19118	Small Fin Seal Mohair	5
11	20502	Sill Block (M607)	2
12	20312	#8 PHP - TEK, 3/4", SS, Clear	5
13	20404	#10 OH - A, 2-1/2", Zinc, Gold	1
14	26756	#10 FHP - A, 3", SS, Clear	1
15	25757	Q-Lon Foam Seal	8
16	23007	L Clips with 4-hole, Clear	1
17	20278	#10-32 FHP - B - UC, 1/2", SS, Clear	2
18	27382	Magnetic Screen Strike Kit	1
19	24067	Strike Plate	1
20	25497	#8-32 FHP, UC, 1/2", SS, Clear	1
21	25498	#8-32 Nylon-Insert Hex Locknut, SS	1
22	24068	Backup Plate (With Dust Cover)	1

Description

Frame B.O.M.

File Name

Series 3000 OXOL
Assembly

REV
H

Released

12/3/2025

SHEET 3 OF 8

PROPRIETARY AND CONFIDENTIAL

THE INFORMATION CONTAINED IN THIS DRAWING IS THE SOLE PROPERTY OF FLEETWOOD WINDOWS & DOORS.
ANY REPRODUCTION IN PART OR AS A WHOLE WITHOUT THE WRITTEN PERMISSION OF FLEETWOOD WINDOWS & DOORS IS PROHIBITED.

ASSEMBLY / PARTS LIST (B.O.M.)

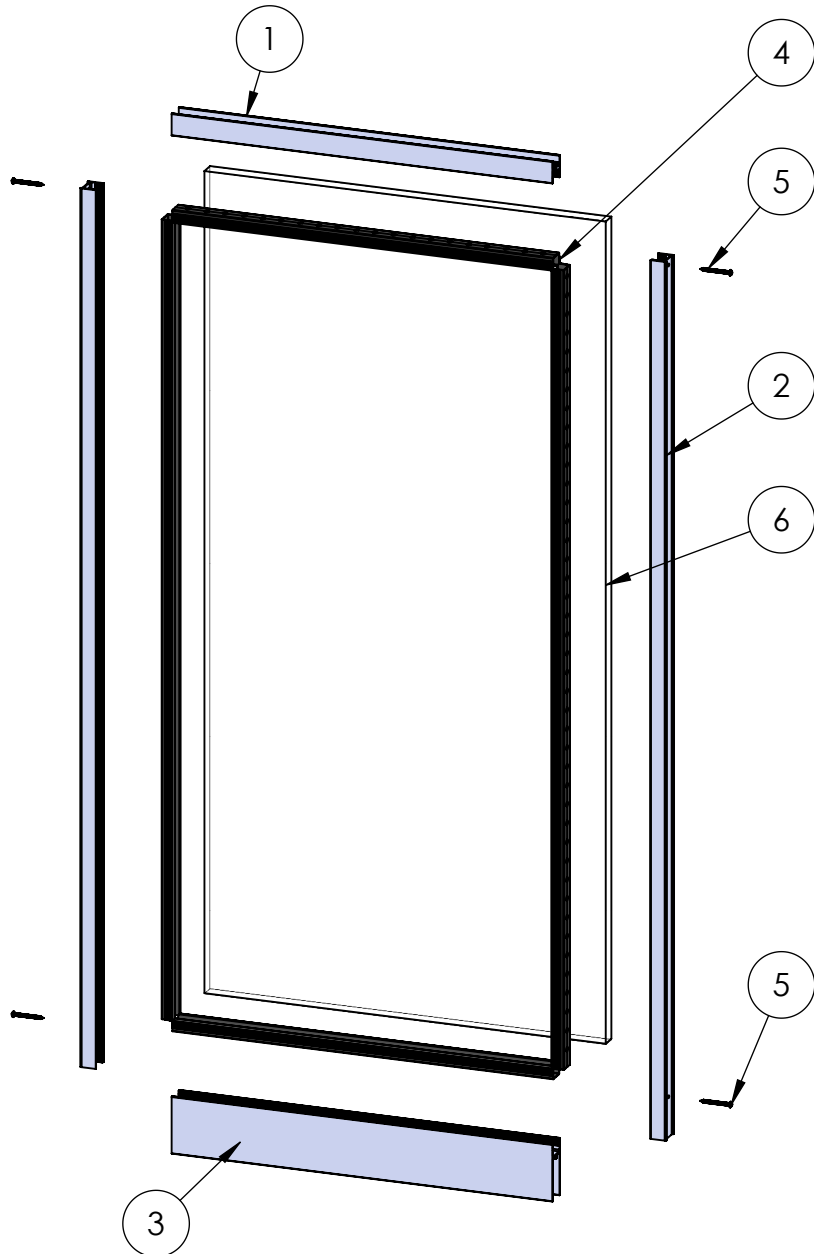

EXTRUSIONS

ITEM NO.	PART NUMBER	DESCRIPTION	QTY.
1	3004	Top Rail	1
2	3008	Fixed Stile	2
3	3010	Bottom Rail	1

HARDWARE

ITEM NO.	PART NUMBER	DESCRIPTION	QTY.
4	22909	1" Glazing Vinyl	1
5	20355	#10 PHP - A, 2", SS, Clear	4
6	-	Glass	1

PROPRIETARY AND CONFIDENTIAL

THE INFORMATION CONTAINED IN THIS DRAWING IS THE SOLE PROPERTY OF FLEETWOOD WINDOWS & DOORS.
ANY REPRODUCTION IN PART OR AS A WHOLE WITHOUT THE WRITTEN PERMISSION OF FLEETWOOD WINDOWS & DOORS IS PROHIBITED.

Description

O Panel Fixed

File Name

Series 3000 OXOL
Assembly

REV
H

Released

12/3/2025

SHEET 4 OF 8

ASSEMBLY / PARTS LIST (B.O.M.)

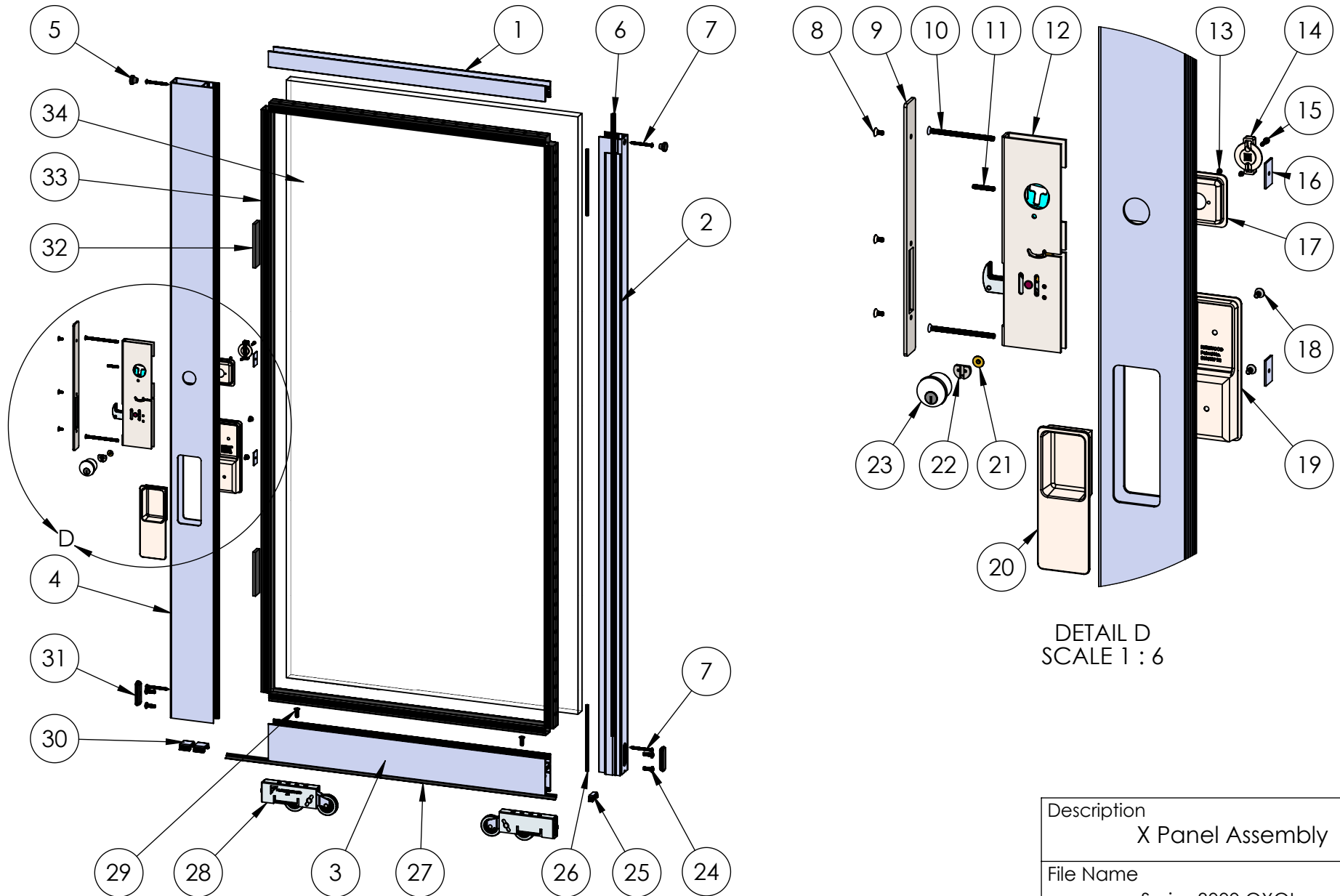

PROPRIETARY AND CONFIDENTIAL

THE INFORMATION CONTAINED IN THIS DRAWING IS THE SOLE PROPERTY OF FLEETWOOD WINDOWS & DOORS.
ANY REPRODUCTION IN PART OR AS A WHOLE WITHOUT THE WRITTEN PERMISSION OF FLEETWOOD WINDOWS & DOORS IS PROHIBITED.

Description X Panel Assembly		
File Name Series 3000 OXOL Assembly		REV H
Released	12/3/2025	SHEET 5 OF 8

ASSEMBLY / PARTS LIST (B.O.M.)

EXTRUSIONS			
ITEM NO.	PART NUMBER	DESCRIPTION	QTY.
1	3004	Top Rail	1
2	3006	Interlocker	1
3	3009	Bottom Rail	1
4	3767	Archetype Lock Stile	1
HARDWARE			
ITEM NO.	PART NUMBER	DESCRIPTION	QTY.
5	20635	Small Round Door Bumper	2
6	19117	Large Fin Seal Mohair	1
7	20355	#10 PHP - A, 2", SS, Clear	4
8	24076	#8-32 FHS, 3/8" Hex Socket Flat SS	3
9	26685	Archetype Latch Face plate, (Thermal)	1
10	25729	#10-32 FHP - B, 3", SS, Clear	2
11	24935	#8-32 x 1" Set Screw	1
12	24070, 24077	Archetype Latch (OX, XO)	1
13	24074	#4-40, FHP, UC, 3/16", SS, Clear	2
14	24079, 24766	Archetype Actuator (Black, SS)	1
15	24072, 24094	#6-32 Hex Socket Head Cap, Self Locking, 1/2", SS (Clear Black)	1
16	18671	Back Up Plate	2
17	24080, 24765, 24081, 24767	Archetype Actuator Pocket, (OX (Black, SS), XO (Black, SS))	1

HARDWARE			
ITEM NO.	PART NUMBER	DESCRIPTION	QTY.
18	24087, 24093	#10-32 FHS Hex Screw, 7/16", (SS, Black)	2
19	24089, 24091	Archetype Handle, Inside	1
20	24090, 24092	Archetype Handle, Outside (SS, Black)	1
21	25681	Brass Bushing - Key Cylinder	1
22	24780	Cam - Key Cylinder	1
23	18679, 18682, 18683, 18686	Key Cylinder [K/A (Black, S.S.), K/D (Black, S.S.)]	1
24	20358	#1/4-20 PHP - B, 3/4", SS, Clear	4
25	19142	Bottom Vent Clip (Small)	1
26	26728	Screen Spline .230 6"	2
27	19064	Sill Wipe, Bottom Wipe	1
28	20514	A2 Roller Precision Tandem	2
29	20305	#1/4-20 FHP - B, 3/4", SS	2
30	19141	Bottom Vent Clip (Large)	2
31	18630	Oval Plug - Short	2
32	18620	Setting Block 1/4" x 1" x 4"	2
33	22909	1" Glazing Vinyl	1
34	-	Glass	1

PROPRIETARY AND CONFIDENTIAL

THE INFORMATION CONTAINED IN THIS DRAWING IS THE SOLE PROPERTY OF FLEETWOOD WINDOWS & DOORS.
ANY REPRODUCTION IN PART OR AS A WHOLE WITHOUT THE WRITTEN PERMISSION OF FLEETWOOD WINDOWS & DOORS IS PROHIBITED.

Description X Panel B.O.M.		
File Name Series 3000 OXOL Assembly		REV H
Released	12/3/2025	SHEET 6 OF 8

ASSEMBLY / PARTS LIST (B.O.M.)

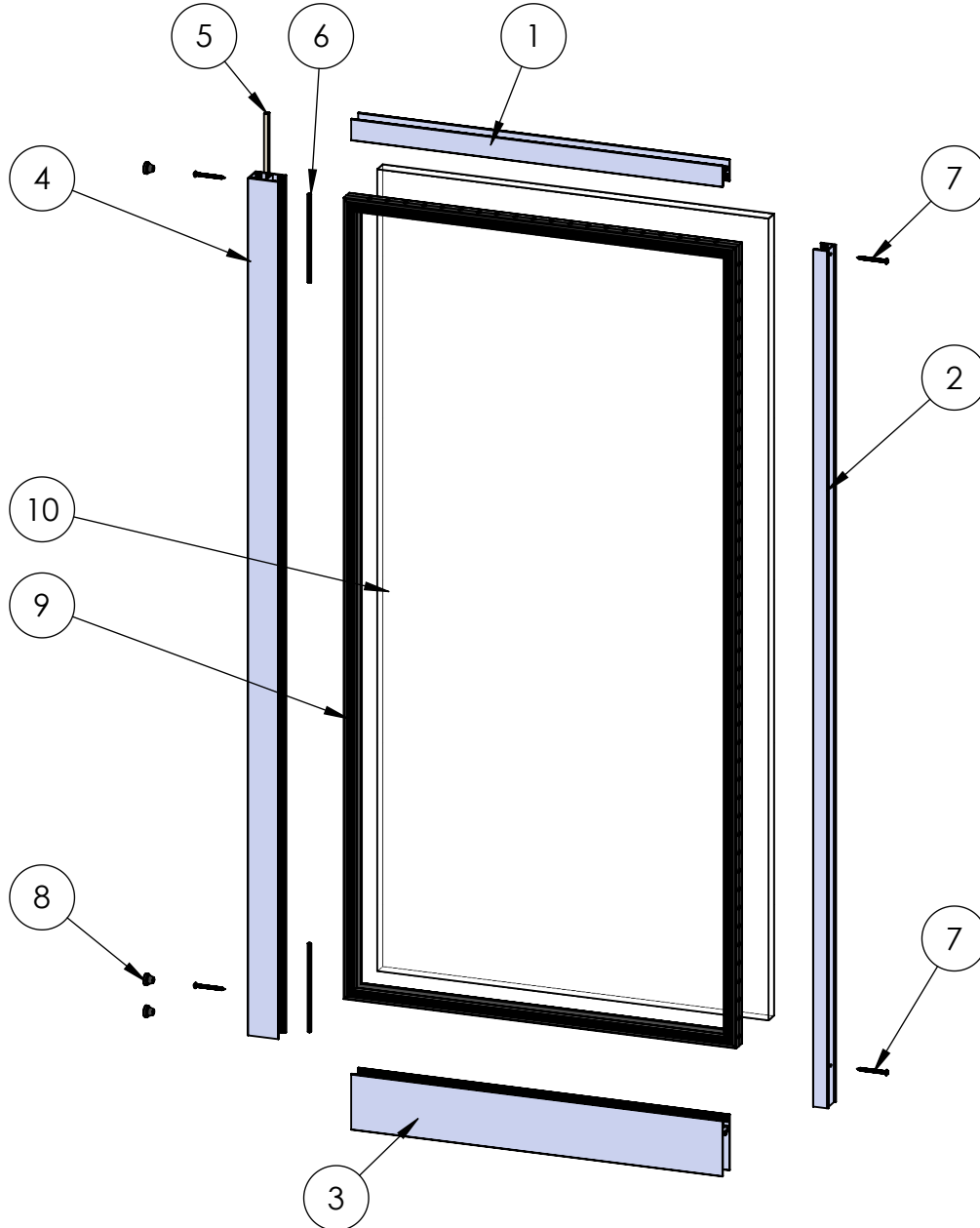

EXTRUSIONS

ITEM NO.	PART NUMBER	DESCRIPTION	QTY.
1	3004	Top Rail	1
2	3008	Fixed Stile	1
3	3010	Bottom Rail	1
4	3006	Interlocker	1

HARDWARE

ITEM NO.	PART NUMBER	DESCRIPTION	QTY.
5	19117	Large Fin Seal Mohair	1
6	26728	Screen Spline .230 6"	2
7	20355	#10 PHP - A, 2", SS, Clear	4
8	20635	Small Round Door Bumper	3
9	22909	1" Glazing Vinyl	1
10	-	Glass	1

PROPRIETARY AND CONFIDENTIAL

THE INFORMATION CONTAINED IN THIS DRAWING IS THE SOLE PROPERTY OF FLEETWOOD WINDOWS & DOORS.
ANY REPRODUCTION IN PART OR AS A WHOLE WITHOUT THE WRITTEN PERMISSION OF FLEETWOOD WINDOWS & DOORS IS PROHIBITED.

Description

O Panel

File Name

Series 3000 OXOL
Assembly

REV
H

Released

12/3/2025

SHEET 7 OF 8

ASSEMBLY / PARTS LIST (B.O.M.)

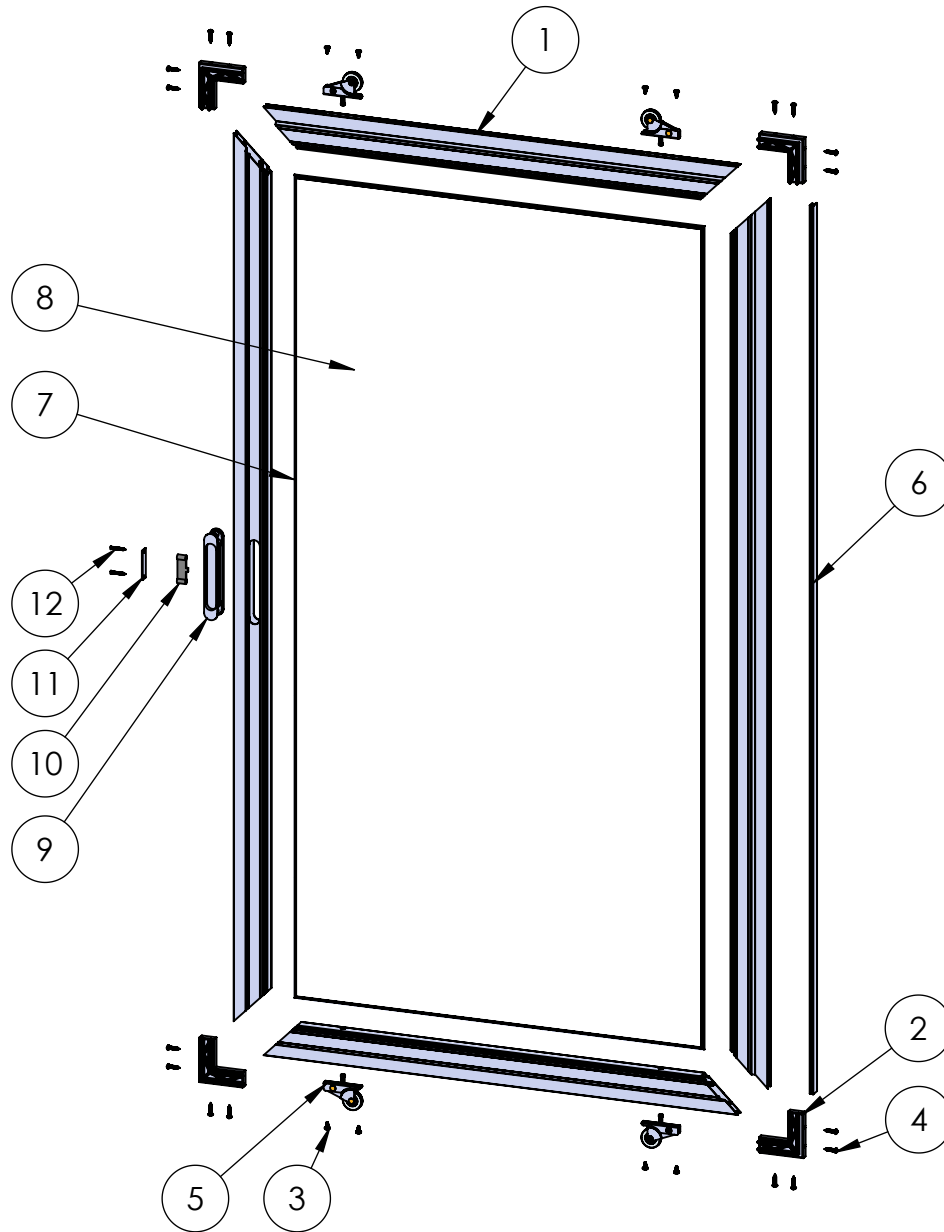

EXTRUSIONS

ITEM NO.	PART NUMBER	DESCRIPTION	QTY.
1	145	Screen Extrusion	4

HARDWARE

ITEM NO.	PART NUMBER	DESCRIPTION	QTY.
2	20489	Door Screen Corner Key	4
3	20225	#6 PHP - TEK, 3/8", SS, Clear	8
4	20314	#8 PHP - A, 3/4", SS, Clear	16
5	22905	Screen Roller	4
6	20531	Door Screen Bug Wiper	1
7	19130	Screen Rubber Spline .160	1
8	-	Screen Mesh	1
9	27381	Screen Handle	1
10	27383	Magnetic Catch Spacer	1
11	27386	Magnetic Catch Strike	1
12	27388	#6 FHP, #4 Head - A, 1", SS, Clear	2

Description
Screen Assembly

File Name
Series 3000 OXOL
Assembly

REV
H

Released 12/3/2025

SHEET 8 OF 8

PROPRIETARY AND CONFIDENTIAL

THE INFORMATION CONTAINED IN THIS DRAWING IS THE SOLE PROPERTY OF FLEETWOOD WINDOWS & DOORS.
ANY REPRODUCTION IN PART OR AS A WHOLE WITHOUT THE WRITTEN PERMISSION OF FLEETWOOD WINDOWS & DOORS IS PROHIBITED.