



Series 3800-T w/ Series 350-T Aluminum Awning Window w/ Thermal Break Frame "IMPACT"

GENERAL NOTES

- This product has been evaluated and is in compliance with the 7th Edition (2020) Florida Building Code (FBC) structural requirements including the "High Velocity Hurricane Zone" (HVHZ).
- Product anchors shall be as listed and spaced as shown on details. Anchor embedment to base material shall be beyond wall dressing or stucco.
- When used in the "HVHZ" this product complies with Section 1626 of the Florida Building Code and does not require an impact resistant covering.
- When used in areas outside of the "HVHZ" requiring wind borne debris protection this product complies with FBC Sections 1609.1.2 & R301.2.1.2 and does not require an impact resistant covering. This product meets missile level "D" and includes Wind Zone 4 as defined in ASTM E 1996 and FBC Sections 1609.1.2.2 & R301.2.1.2.1.
- For 2x stud framing construction, anchoring of these units shall be the same as that shown for 2x buck masonry construction.
- Site conditions that deviate from the details of this drawing require further engineering analysis by a licensed engineer or registered architect.
- This product meets water infiltration requirements for "HVHZ".
- Gaskets and setting blocks shall comply with Section 2411.3.4 of the FBC.
- Aluminum components, including fasteners, shall meet the requirements of FBC Section 2003.

TABLE OF CONTENTS	
SHEET#	DESCRIPTION
1	Typical elevations, design pressures and general notes
2	Horizontal cross sections
3	Vertical cross sections
4	Horizontal and vertical cross sections
5	Buck and frame anchoring
6	Buck and frame anchoring
7	Glazing detail
8	Bill of materials and components

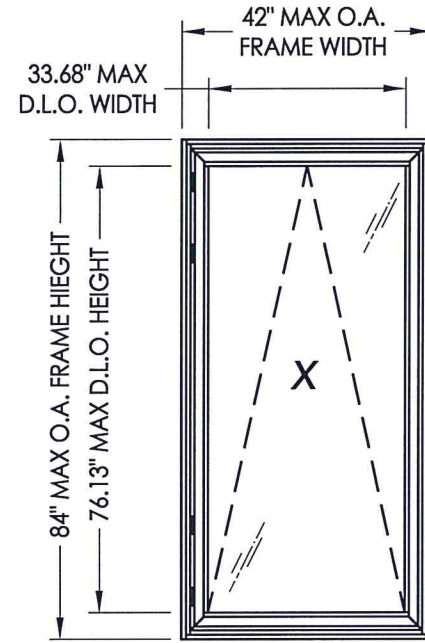

FRAME MOUNT

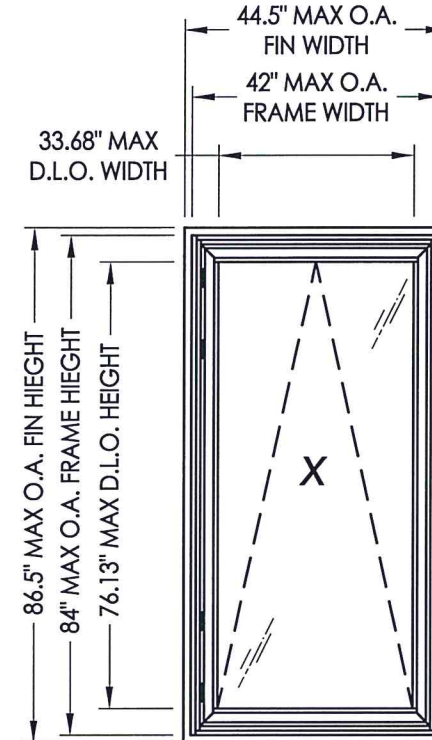

FIN MOUNT

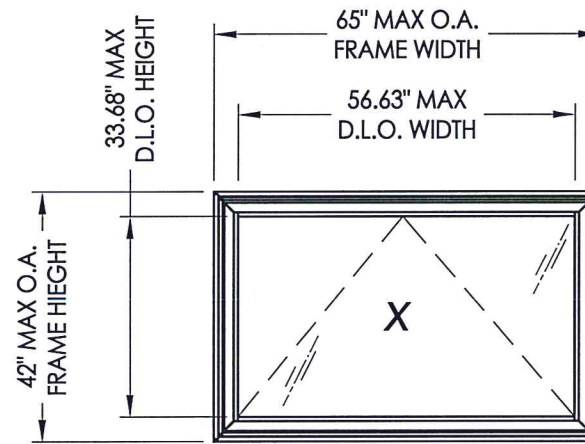

FRAME MOUNT

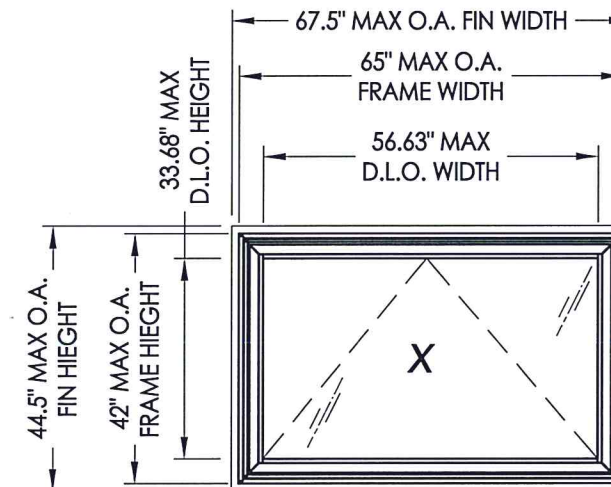

FIN MOUNT

OVERALL FIN DIMENSION	OVERALL FRAME DIMENSION	OVERALL D.L.O. DIMENSION	GLASS TYPE	DESIGN PRESSURE (PSF)	
				POSITIVE	NEGATIVE
44.5" X 86.5"	42" X 84"	33.68" X 76.13"	G1, G2, G3, G4, G5, G6	+65.0	-65.0
44.5" X 47.5"	42" X 45"	33.68" X 37.88"	G1, G2, G3, G4, G5, G6	+65.0	-65.0
67.5" X 44.5"	65" X 42"	56.63" X 33.68"	G1, G2, G3, G4, G5, G6	+65.0	-65.0

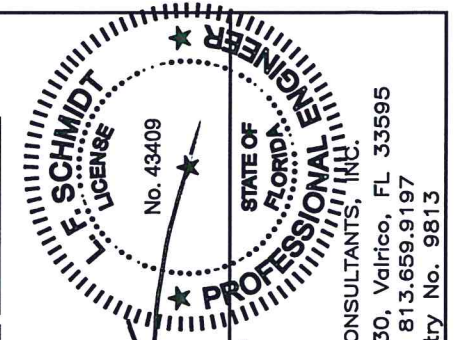

December 8, 2021
 Documents Prepared By:
 Lyndon F. Schmidt
 P.E. No. 43409
 R.W. BUILDING CONSULTANTS, INC.
 P.O. Box 230, Valrico, FL 33595
 Phone No.: 813.659.9197
 FBPE Registry No. 9813

PRODUCT: FLEETWOOD WINDOWS AND DOORS
 PART OR ASSEMBLY: TYPICAL ELEVATION, DESIGN PRESSURES & GENERAL NOTES

NO.	DATE	REVISIONS
6	12/08/21	SERIES NAME CHANGE
5	8/10/20	UPDATE TO 7TH ED. (2020) FBC
4	8/07/17	UPDATE TO 6TH ED. (2017) FBC
3	8/22/16	RENUMBER DRAWINGS
2	1/22/15	UPDATE TO 5TH ED. (2014) FBC
1	4/24/14	ADD FRAME SIZE

DATE: 10/23/13
 SCALE: N.T.S.
 DWG. BY: JK
 CHK. BY: LFS
 DRAWING NO.: FL-14907.3
 SHEET 1 OF 8

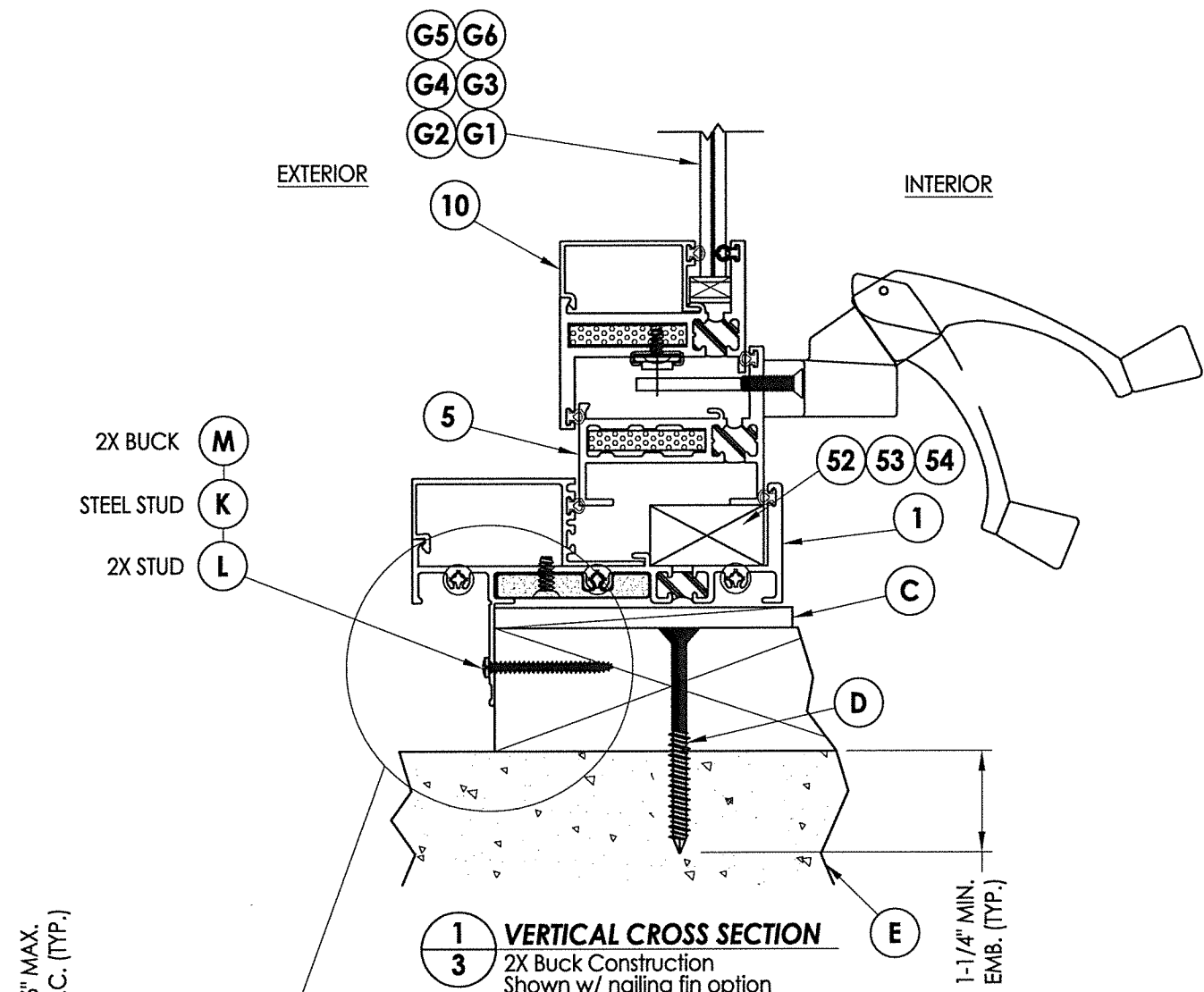

1 VERTICAL CROSS SECTION
3 2X Buck Construction
 Shown w/ nailing fin option

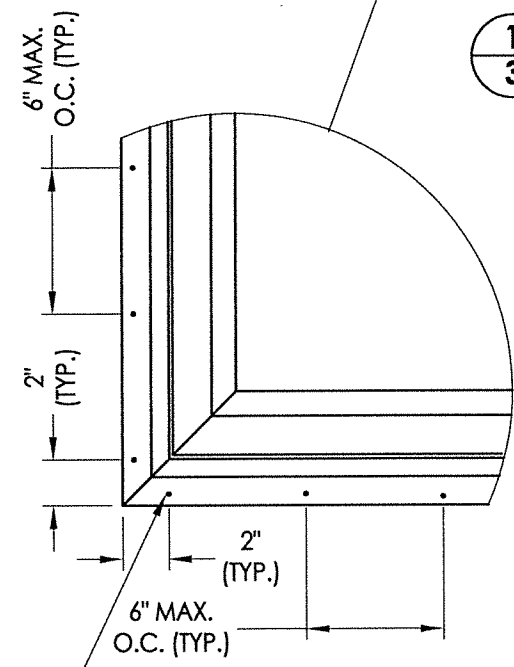

WOOD BUCK/STUD: #8 PPH WOOD SCREW (Must penetrate a min. of 1-3/8" into wood substrate)
 STEEL STUD: #10 PPH SELF-DRILLING SMS (Must penetrate a min. of 3 threads through 0.033" min. thick steel)
 (NOTE: Maintain 1/2" minimum edge distance for wood and sheet metal screws)

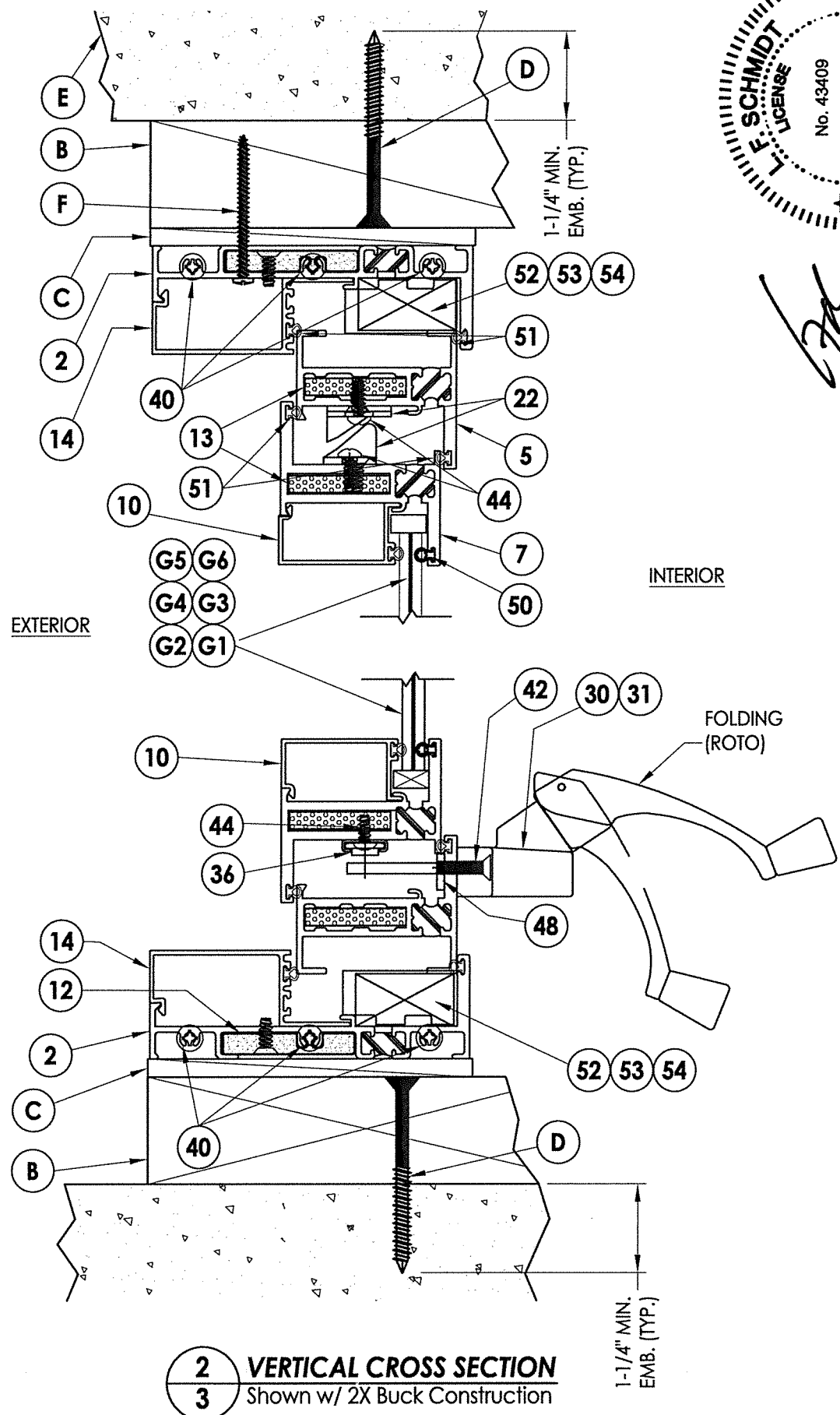

2 VERTICAL CROSS SECTION
3 Shown w/ 2X Buck Construction

December 8, 2021
 Documents Prepared By:
 Lyndon F. Schmidt
 P.E. No. 43409

RW BUILDING CONSULTANTS, INC.
 P.O. Box 230, Valrico, FL 33595
 Phone No.: 813.659.9197
 FBPE Registry No. 9813

PRODUCT:		FLEETWOOD WINDOWS AND DOORS			
PART OR ASSEMBLY:		VERTICAL CROSS SECTIONS			
6	12/08/21	SERIES NAME CHANGE	LFS		
5	8/10/20	UPDATE TO 7th ED. (2020)	FBC	DAC	
4	8/07/17	UPDATE TO 6th ED. (2017)	FBC	LFS	
3	8/22/16	RENUMBER DRAWINGS		JK	
2	1/22/15	UPDATE TO 5th ED. (2014)	FBC	LFS	
1	4/24/14	ADD FRAME SIZE		JK	
	NO.	DATE		BY	
DATE:		10/23/13			
SCALE:		N.T.S.			
DWG. BY:		JK			
CHK. BY:		LFS			
DRAWING NO.:		FL-14907.3			
SHEET		3 of 8			

Z:\Clients\Fleetwood PERMANENT\A - Florida Product Approvals\FL-14907 AwningC - Drawings\FL-14907 (2020) R10\FL-14907.1-3.dwg

NOTE:
1. Item #35 located 17"
from each end (2) total.

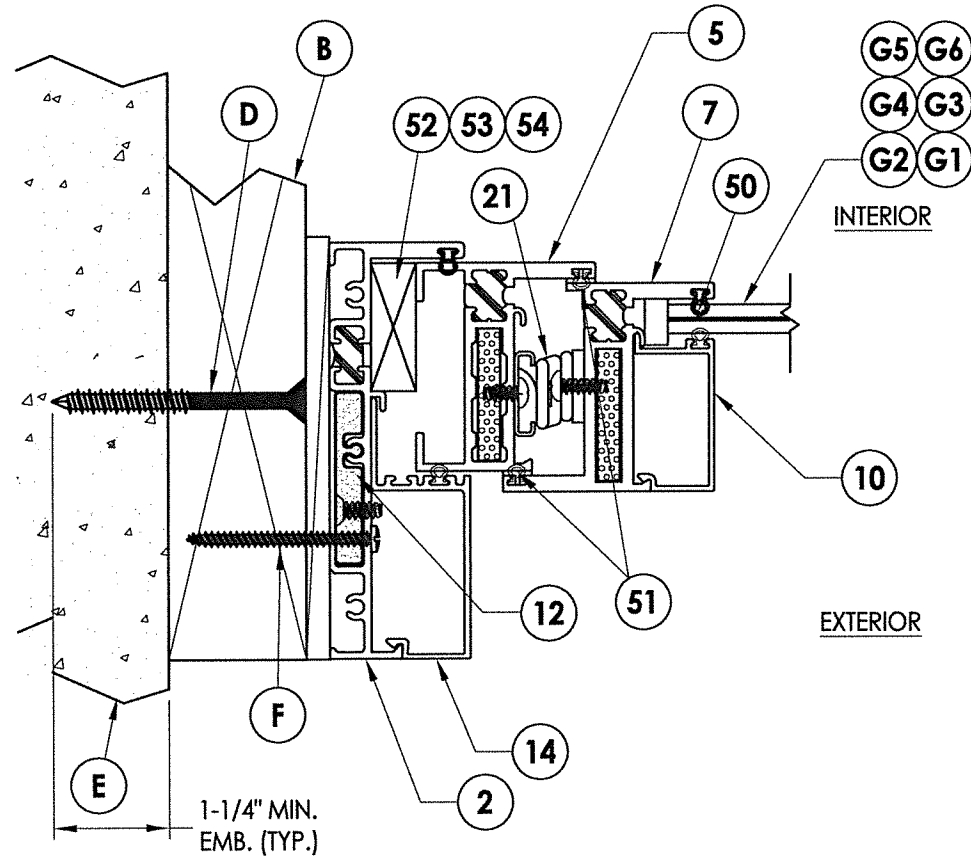
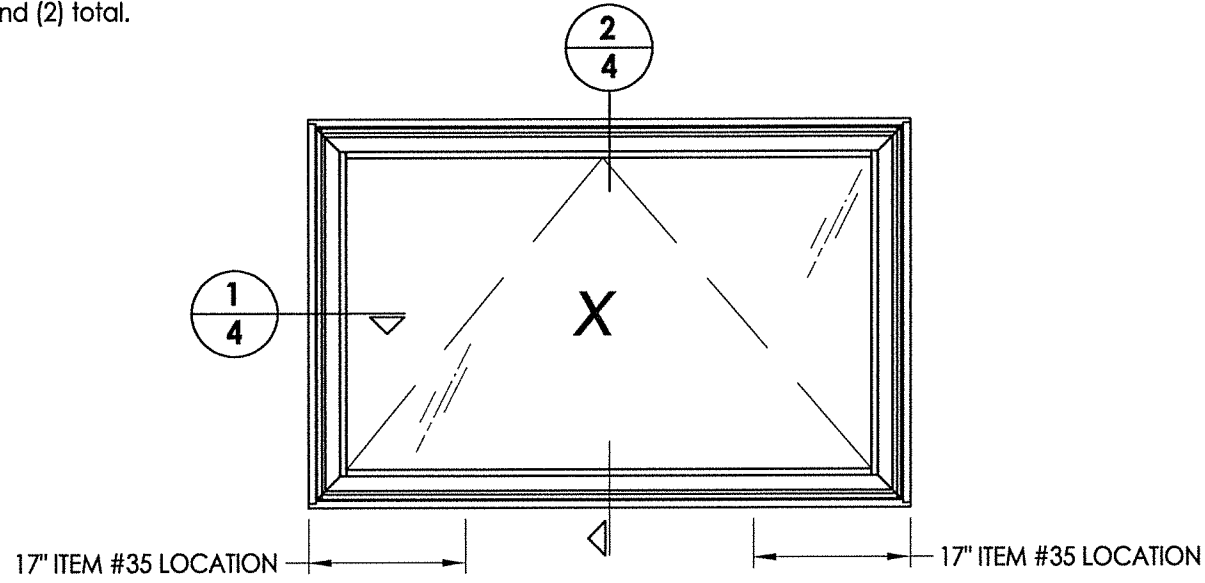

1 **HORIZONTAL CROSS SECTION**
4 Shown w/ 2X Buck Construction

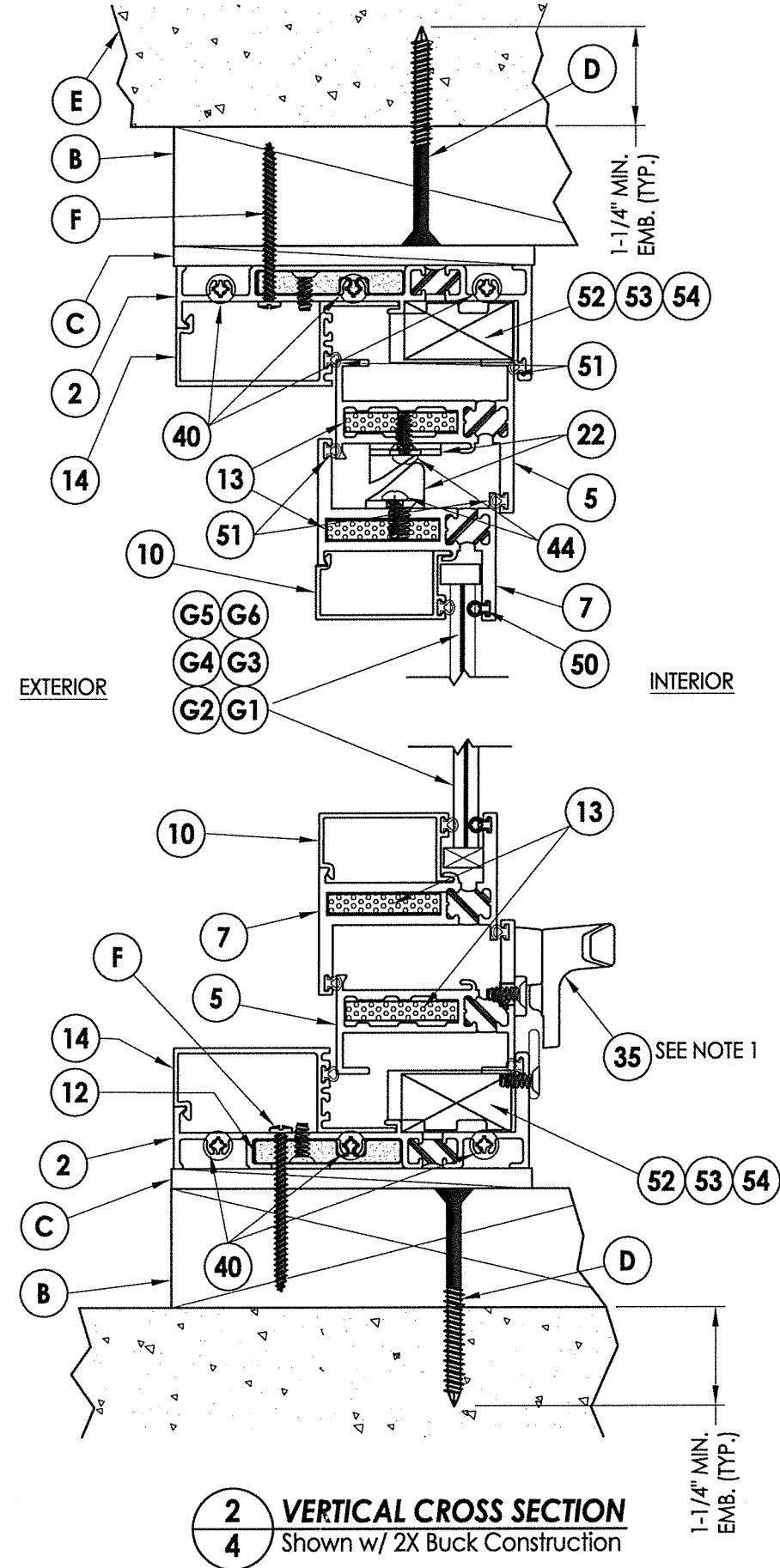

2 **VERTICAL CROSS SECTION**
4 Shown w/ 2X Buck Construction

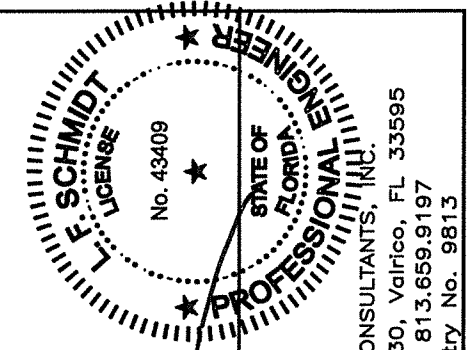

December 8, 2021
Documents Prepared By:
Lyndon F. Schmidt
P.E. No. 43409
RW BUILDING CONSULTANTS, INC.
P.O. Box 230, Valrico, FL 33595
Phone No.: 813.659.9197
FBPE Registry No. 9813

PRODUCT:		FLEETWOOD WINDOWS AND DOORS	
PART OR ASSEMBLY:		HORIZONTAL AND VERTICAL CROSS SECTIONS	
LFS	12/08/21	SERIES NAME CHANGE	JK
DAC	8/10/20	UPDATE TO 7th ED. (2020)	FBC
LFS	8/07/17	UPDATE TO 6th ED. (2017)	FBC
LFS	8/22/16	RENUMBER DRAWINGS	JK
LFS	1/22/15	UPDATE TO 5th ED. (2014)	FBC
JK	4/24/14	ADD FRAME SIZE	JK
BY	NO.	DATE	
DATE: 10/23/13			
SCALE: N.T.S.			
DWG. BY: JK			
CHK. BY: LFS			
DRAWING NO.: FL-14907.3			
SHEET 4 OF 8			

© 2013 R.W. BUILDING CONSULTANTS INC.

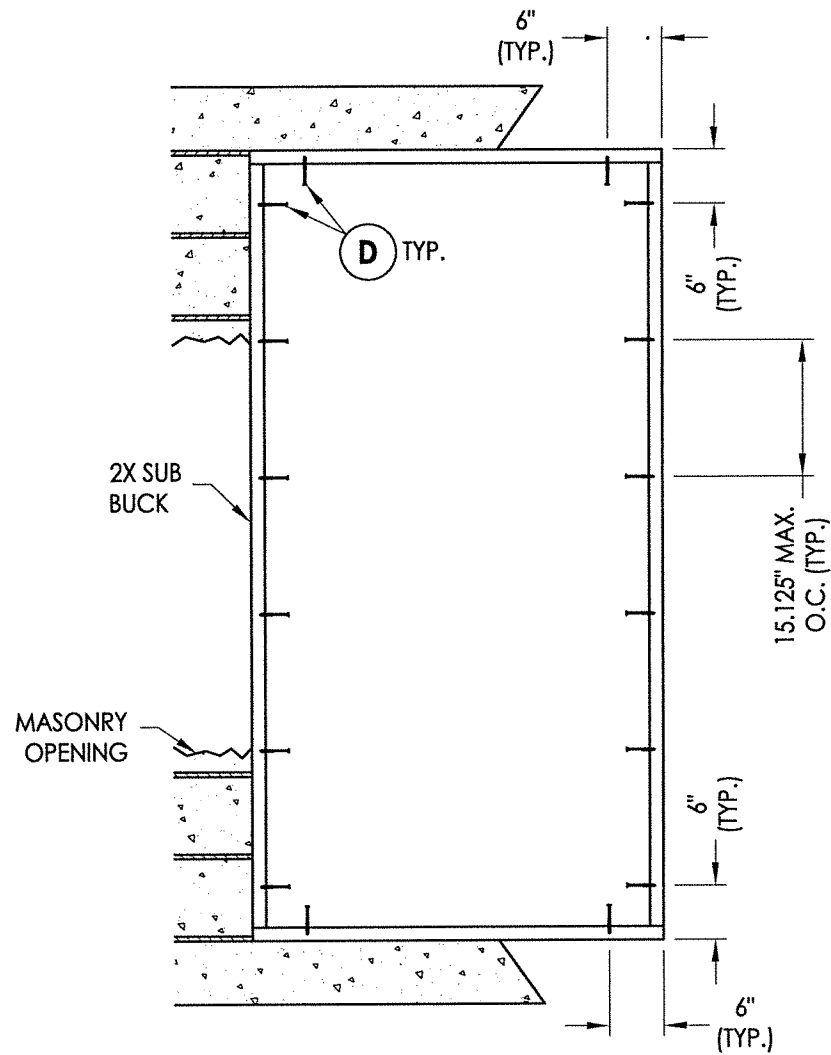

2X BUCK ANCHORING
42" X 84" Max Size

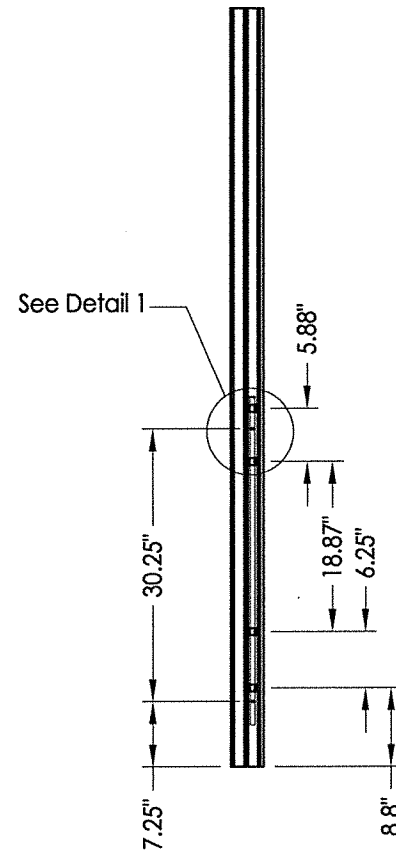

LOCK JAMB
2 Point Lock

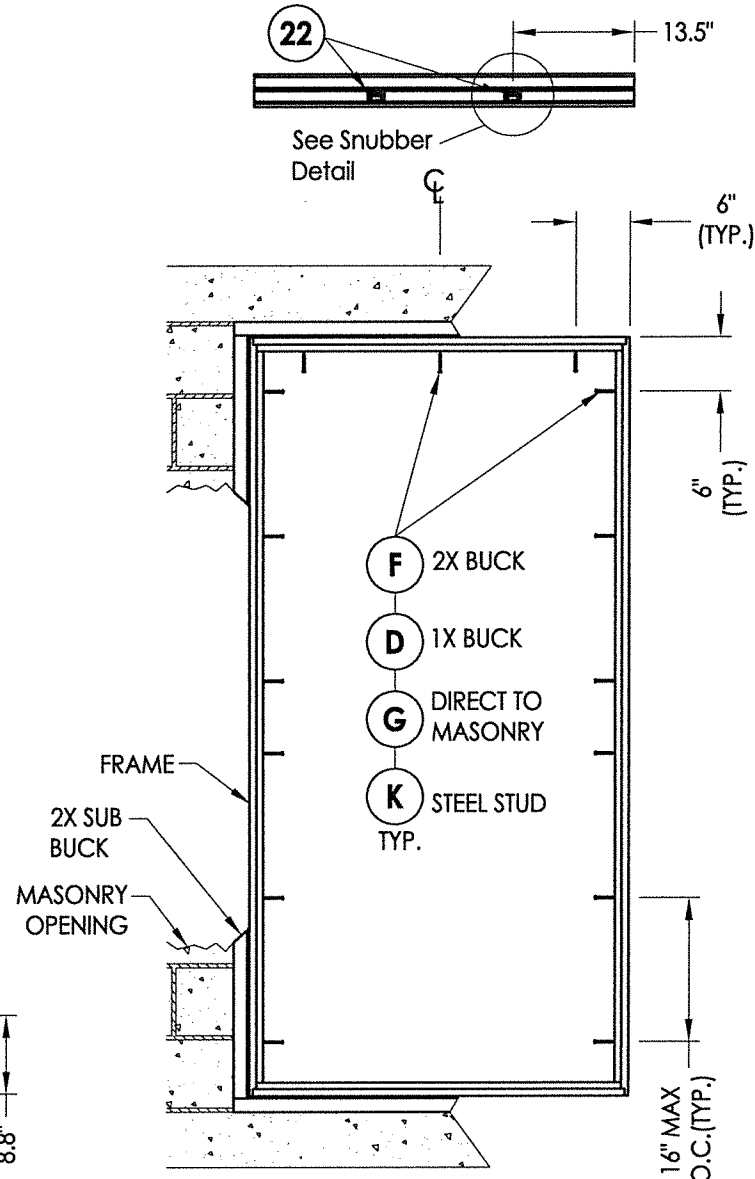

FRAME MOUNT ANCHORING
42" X 84" Max Size

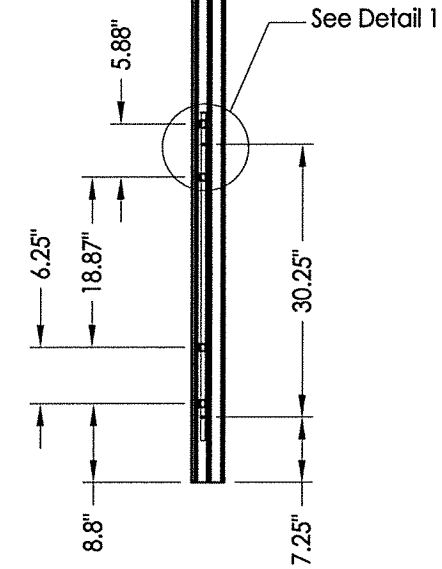

LOCK JAMB
2 Point Lock

CONCRETE ANCHOR NOTES:

1. Concrete anchor locations at the corners may be adjusted to maintain the min. edge distance to mortar joints.
2. Concrete anchor locations noted as "MAX. ON CENTER" must be adjusted to maintain the min. edge distance to mortar joints, additional concrete anchors may be required to ensure the "MAX. ON CENTER" dimension are not exceeded.
3. Concrete anchor table:

ANCHOR TYPE	ANCHOR SIZE	MIN. EMBEDMENT	MIN. CLEARANCE TO MASONRY EDGE	MIN. CLEARANCE TO ADJACENT ANCHOR
ITW TAPCON®	1/4"	1-1/4"	2"	4"
DeWALT ULTRACON®	1/4"	1-1/4"	1"	4"

WOOD SCREW INSTALLATION NOTES:

1. Maintain a minimum 5/8" edge distance, 1" end distance, & 1" o.c. spacing of wood screws to prevent the splitting of wood.

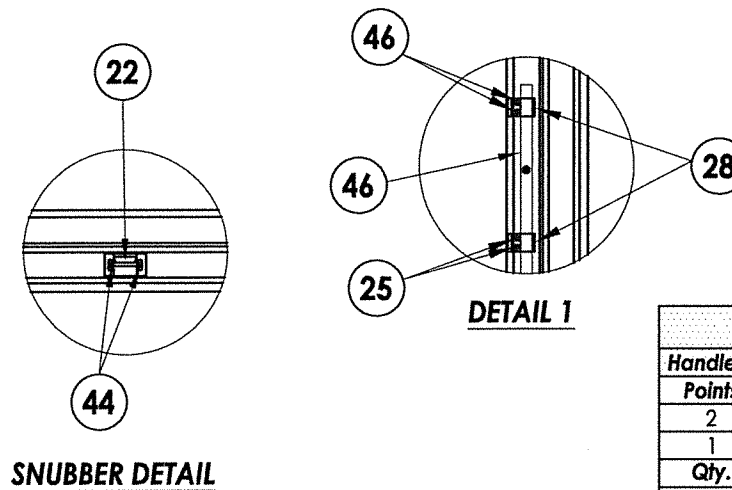

SNUBBER DETAIL

HARDWARE TABLE			
Points	Description	Height	
2	Multipoint	> 50"	*Cam locks can be used in conjunction with multipoint lock or in lieu of multipoint locks
1	Multipoint	≤ 50"	
Qty.			
2	Cam*	≤ 50"	

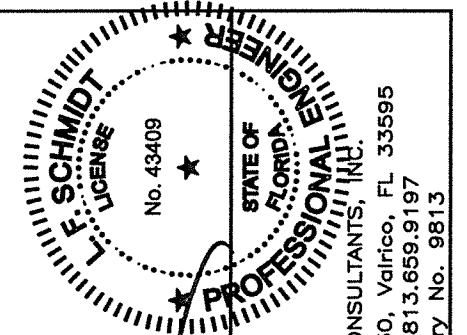

December 8, 2021
Documents Prepared By:
Lyndon F. Schmidt
P.E. No. 43409

R.W. BUILDING CONSULTANTS, INC.
P.O. Box 230, Valrico, FL 33595
Phone No.: 813.659.9197
FBPE Registry No. 9813

PRODUCT: FLEETWOOD WINDOWS AND DOORS
PART OR ASSEMBLY: BUCK & FRAME ANCHORING

NO.	DATE	REVISIONS
6	12/08/21	SERIES NAME CHANGE
5	8/10/20	UPDATE TO 7TH ED. (2020) FBC
4	8/07/17	UPDATE TO 6TH ED. (2017) FBC
3	8/22/16	RENUMBER DRAWINGS
2	1/22/15	UPDATE TO 5TH ED. (2014) FBC
1	4/24/14	ADD FRAME SIZE

DATE: 10/23/13
SCALE: N.T.S.
DWG. BY: JK
CHK. BY: LFS
DRAWING NO.: FL-14907.3
SHEET 5 OF 8

Z:\Clients\Fleetwood PERMANENTA - Florida Product Approvals\FL-14907 Awning\C - Drawings\FL-14907 (2020) R10\FL-14907.1-3.dwg

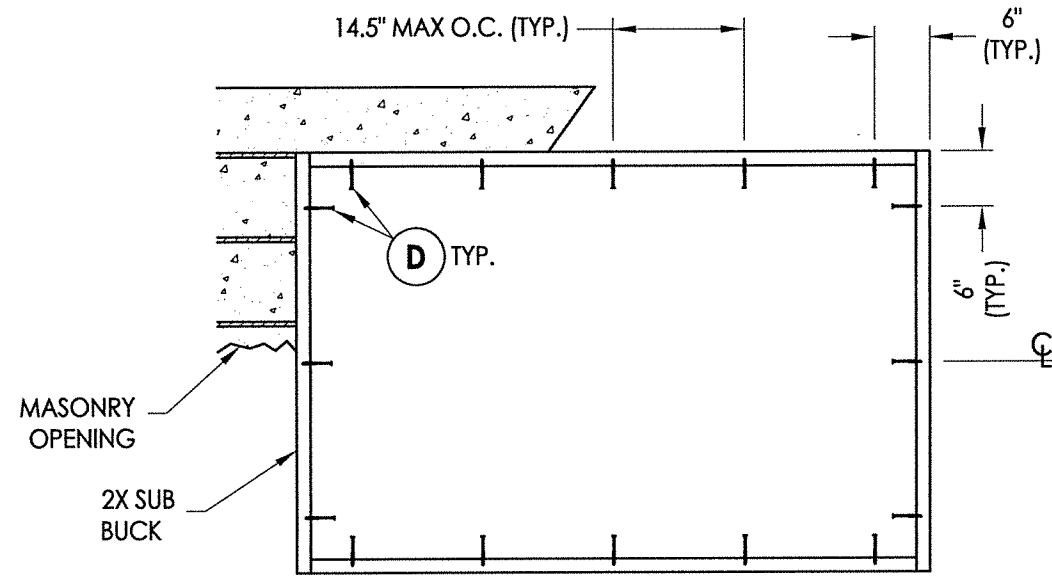

2X BUCK ANCHORING
65" X 42" Max Size

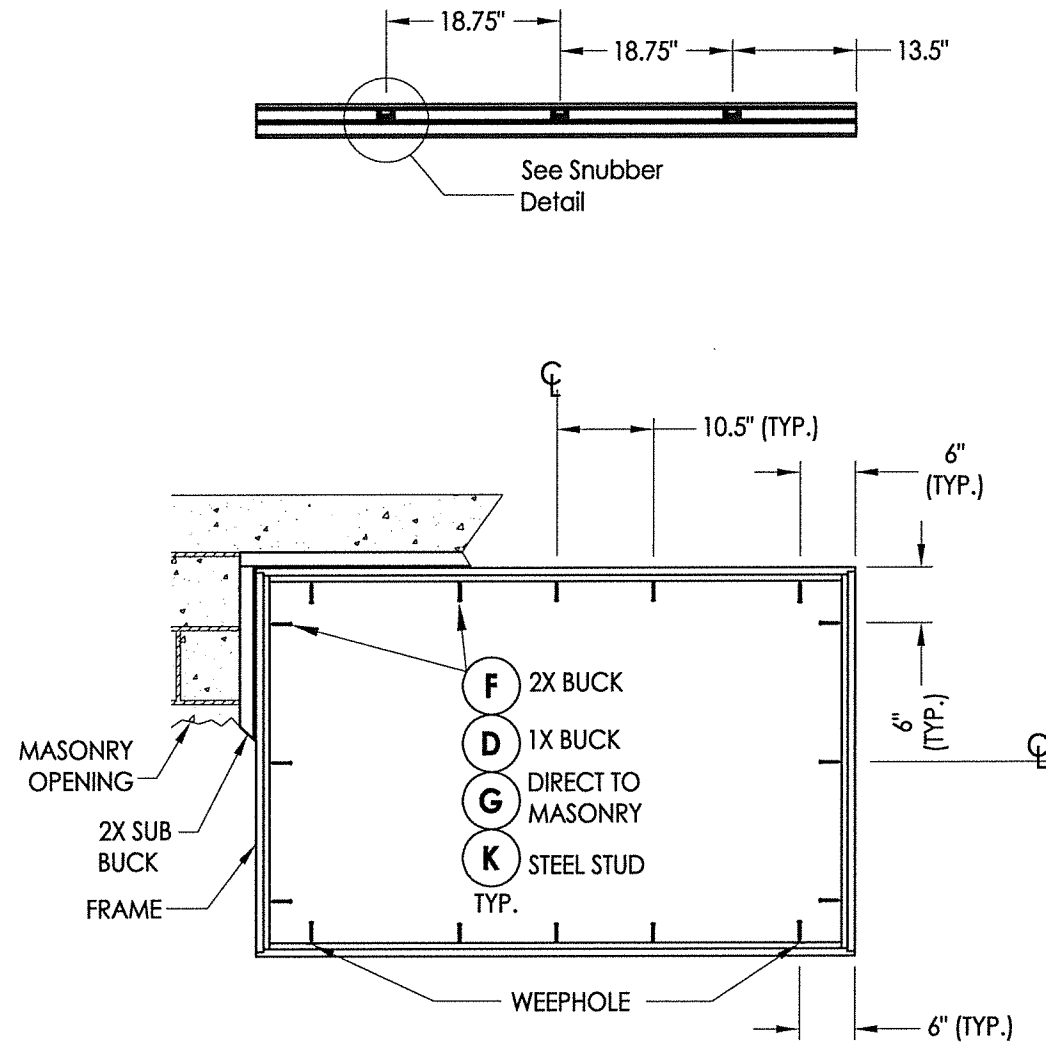

FRAME MOUNT ANCHORING
65" X 42" Max Size

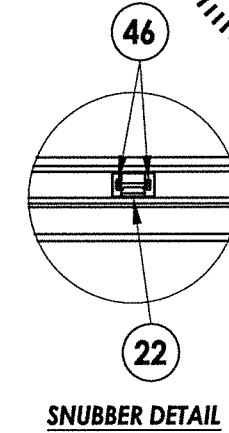

SNUBBER DETAIL

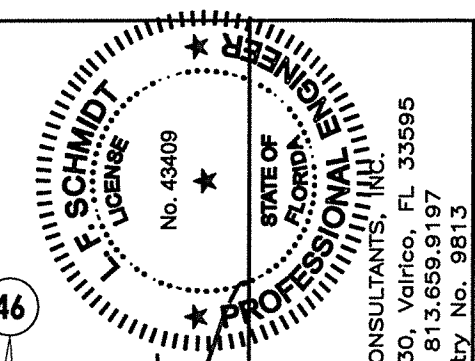
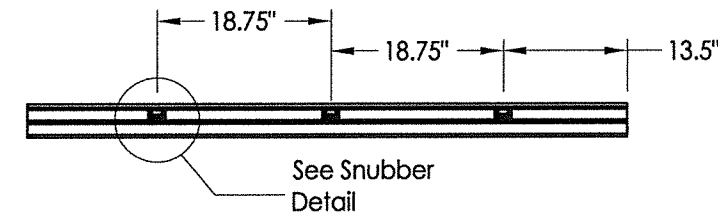

December 8, 2021
 Documents Prepared By:
 Lyndon F. Schmidt
 P.E. No. 43409
 R.W. BUILDING CONSULTANTS, INC.
 P.O. Box 230, Valrico, FL 33595
 Phone No.: 813.659.9197
 FBPE Registry No. 9813

CONCRETE ANCHOR NOTES:

- Concrete anchor locations at the corners may be adjusted to maintain the min. edge distance to mortar joints.
- Concrete anchor locations noted as "MAX. ON CENTER" must be adjusted to maintain the min. edge distance to mortar joints, additional concrete anchors may be required to ensure the "MAX. ON CENTER" dimension are not exceeded.
- Concrete anchor table:

ANCHOR TYPE	ANCHOR SIZE	MIN. EMBEDMENT	MIN. CLEARANCE TO MASONRY EDGE	MIN. CLEARANCE TO ADJACENT ANCHOR
ITW TAPCON®	1/4"	1-1/4"	2"	4"
DeWALT ULTRACON+®	1/4"	1-1/4"	1"	4"

WOOD SCREW INSTALLATION NOTES:

- Maintain a minimum 5/8" edge distance, 1" end distance, & 1" o.c. spacing of wood screws to prevent the splitting of wood.

PRODUCT:		FLEETWOOD WINDOWS AND DOORS	
PART OR ASSEMBLY:		BUCK & FRAME ANCHORING	
LFS	DAC	FBC	FBC
JK	JK	JK	JK
LFS	FBC	FBC	FBC
JK	JK	JK	JK
BY	BY	BY	BY
NO.	DATE	REVISIONS	
6	12/08/21	SERIES NAME CHANGE	
5	8/10/20	UPDATE TO 7TH ED. (2020)	
4	8/07/17	UPDATE TO 6TH ED. (2017)	
3	8/22/16	RENUMBER DRAWINGS	
2	1/22/15	UPDATE TO 5TH ED. (2014)	
1	4/24/14	ADD FRAME SIZE	
DATE: 10/23/13			
SCALE: N.T.S.			
DWG. BY: JK			
CHK. BY: LFS			
DRAWING NO.: FL-14907.3			
SHEET 6 OF 8			

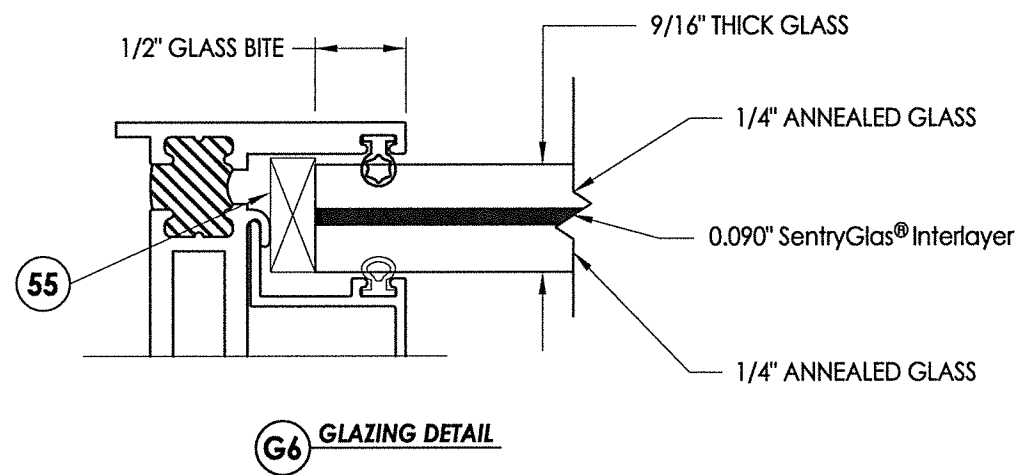
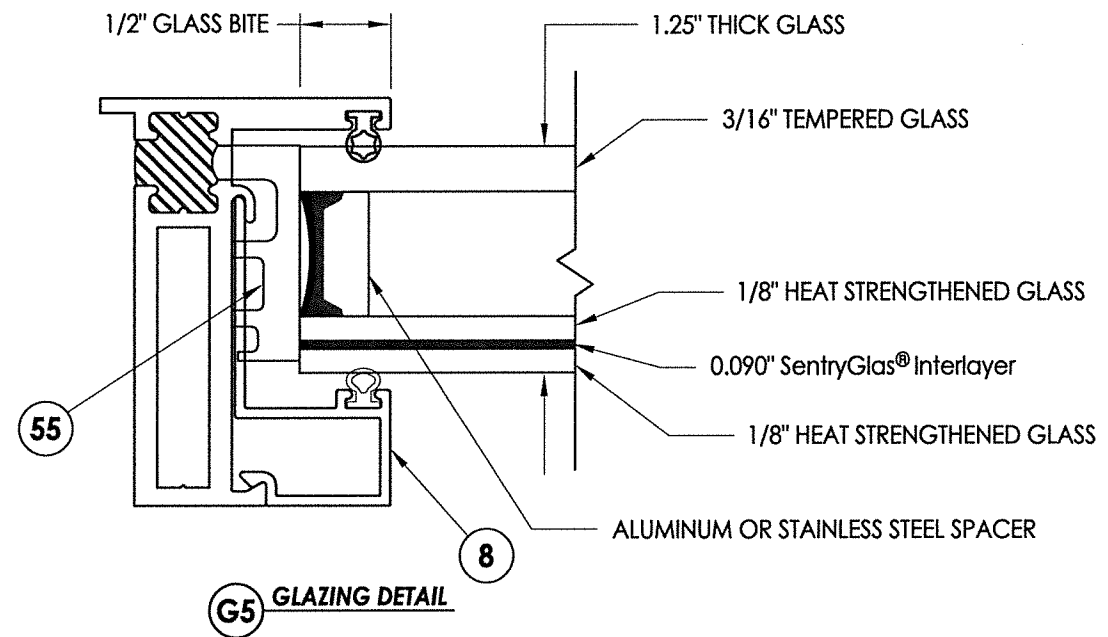
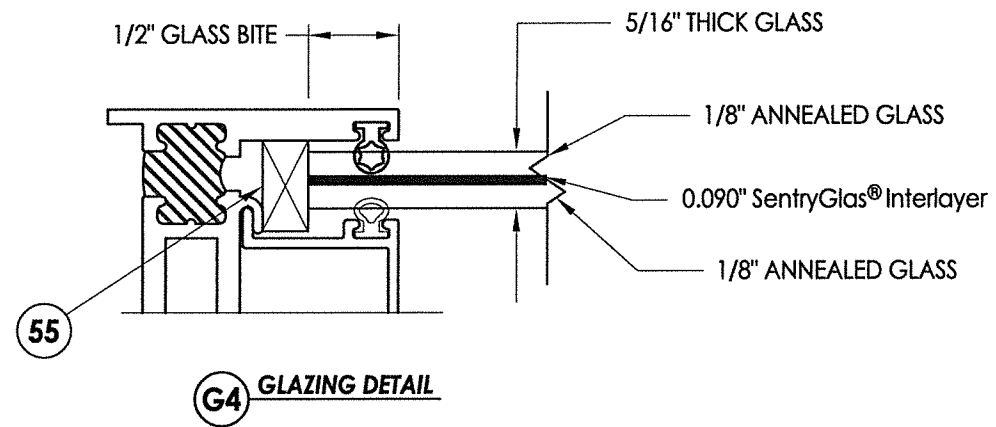
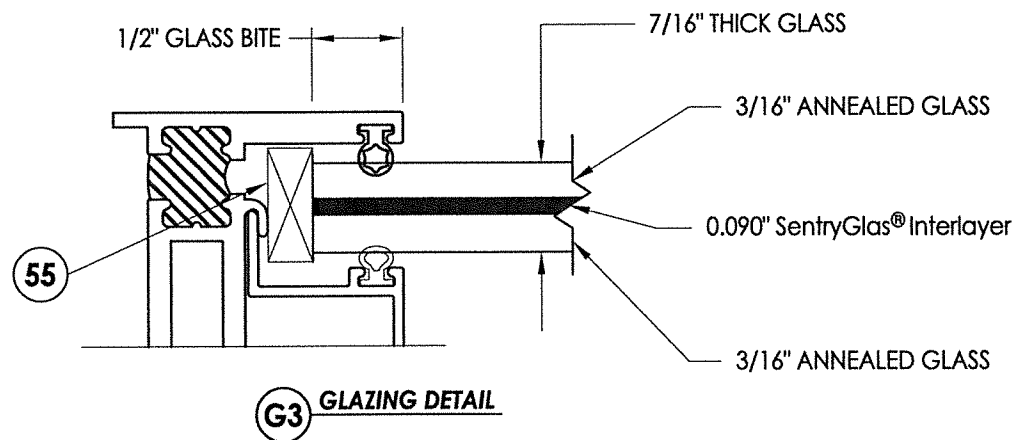
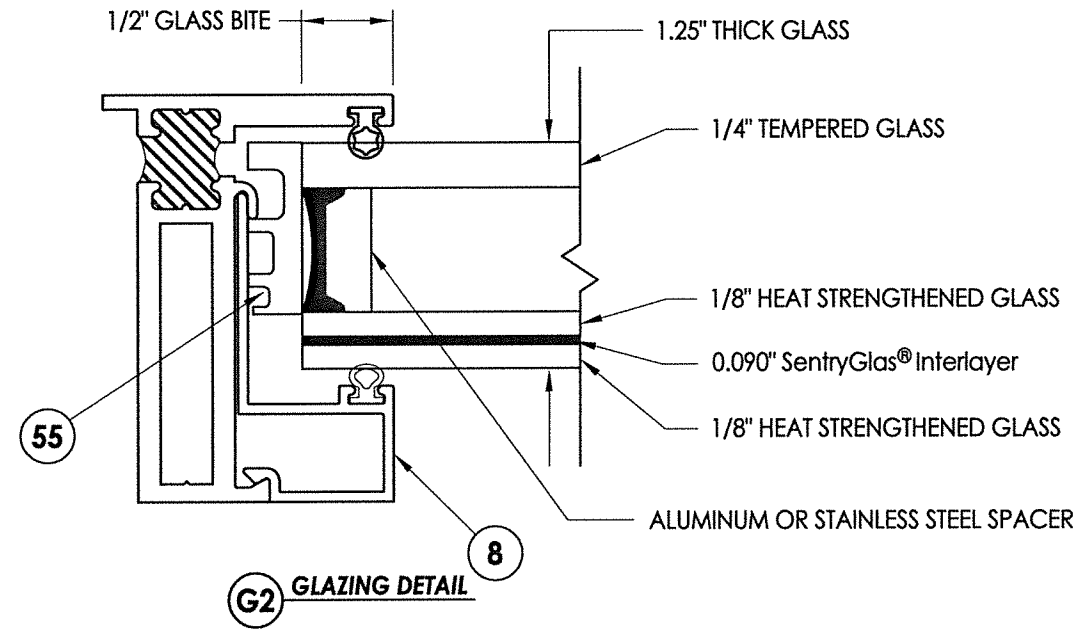
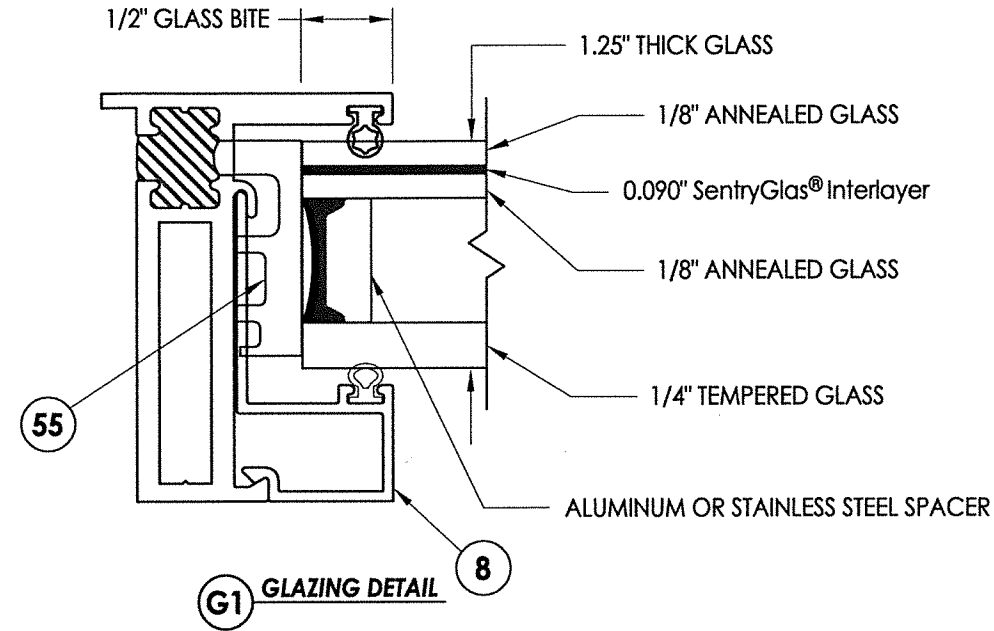

NOTE: GLAZING > 36" WIDE REQUIRES AT LEAST TWO (2) SETTING BLOCKS CONFORMING TO FBC SECTION 2411.3.3.1.

December 8, 2021
 Documents Prepared By:
 Lyndon F. Schmidt
 P.E. No. 43409

R.W.
 BUILDING CONSULTANTS, INC.
 P.O. Box 230, Valrico, FL 33595
 Phone No.: 813.659.9197
 FBPE Registry No. 9813

PRODUCT:		FLEETWOOD WINDOWS AND DOORS	
PART OR ASSEMBLY:		GLAZING DETAILS	
LFS	DAC	LFS	JK
12/08/21	8/10/20	8/07/17	8/22/15
SERIES NAME CHANGE	UPDATE TO 7th ED. (2020)	RENUMBER DRAWINGS	UPDATE TO 5TH ED. (2014)
6	5	4	3
NO.	DATE	NO.	DATE
REVISIONS			
DATE: 10/23/13			
SCALE: N.T.S.			
DWG. BY: JK			
CHK. BY: LFS			
DRAWING NO.: FL-14907.3			
SHEET 7 of 8			

BILL OF MATERIALS		
ITEM #	DESCRIPTION	MATERIAL
A	1X BUCK SG >= 0.55	WOOD
B	2X BUCK SG >= 0.55	WOOD
C	1/4" MAX. SHIM SPACE	-
D	1/4" X 2-3/4" DeWALT OR ITW PFH CONCRETE SCREW	STEEL
E	MASONRY - 3,000 PSI MIN. CONCRETE CONFORMING TO ACI 301 OR HOLLOW BLOCK CONFORMING TO ASTM C90	CONCRETE
F	#10 X 2" PPH WOOD SCREW (1-1/4" MIN. EMBEDMENT)	STEEL
G	1/4" X 2-1/4" DeWALT OR ITW PFH CONCRETE SCREW	STEEL
K	#10 PPH SELF-DRILLING SMS	STEEL
L	#8 PPH SMS (1-3/8" MIN. EMBEDMENT)	STEEL
M	#8 X 1-1/2" PPH SMS (1-3/8" MIN. EMBEDMENT)	STEEL
X	STEEL STUD Min. Thk .033" (ASTM A653 GRADE 33 Fy=33 Ksi Min, Fu=45 Ksi Min)	STEEL
1	FIN BLOCK FRAME (3800-T)	6063-T6 ALUM
2	BLOCK FRAME (3800-T)	6063-T6 ALUM
3	THERMAL BREAK ("LIQUID POLYURETHANE" by Azon USA, Inc.)	-
5	BLOCK FRAME (350-T)	6063-T6 ALUM
7	ZEE BAR (PANEL)	6063-T6 ALUM
8	GLASS STOP (1-1/4")	6063-T6 ALUM
10	GLASS STOP (5/16", 7/16")	6063-T6 ALUM
12	SHEAR BLOCK	6061-T6 ALUM
13	CORNER KEY	6063-T6 ALUM
14	INSERT STOP	6063-T6 ALUM
19	2 BAR HINGE	SS
21	4 BAR HINGE	SS
22	SNUBBER-COMMERCIAL PULL-IN BLOCK	SS
23	MULTIPOINT LOCK HANDLE	SS
24	1 POINT LOCKING BAR (TRUTH)	SS
25	2 POINTS LOCKING BAR (TRUTH)	SS
28	TIE BAR GUIDE (TRUTH)	-
29	KEEPER (TRUTH)	SS
30	CASEMENT ROTOR GEAR 13.5" (TRUTH)	SS
31	CASEMENT ROTOR GEAR 9.5" (TRUTH)	SS
35	CAM HANDLE / STRIKE PLATE	SS
36	CASEMENT SS. TRACK (TRUTH)	SS
40	#10 X 1" PPH SMS	STEEL
42	MACHINE SCREW NO 10-32, FHP .75"	STEEL
44	SCREW NO 8, PPH, .50"	STEEL
46	SCREW NO 8, FHP, .750"	STEEL
48	BACK UP NUTS	STEEL
50	BULB VINYL (EPDM 70 DUROMETER)-TREMCO	-
51	MINI BULB VINYL (EPDM 70 DUROMETER)-TREMCO	-
52	WOOD BLOCK .750" X 1.250"	-
53	ALUMINUM BLOCK .750" X 1.250"	-
54	PVC BLOCK .750" X 1.250"	-
55	SETTING BLOCK (SANTOPRENE - 86 DUROMETER) - TREMCO	-

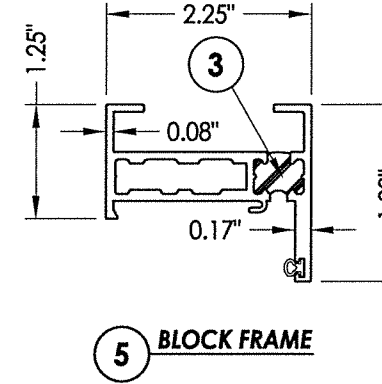
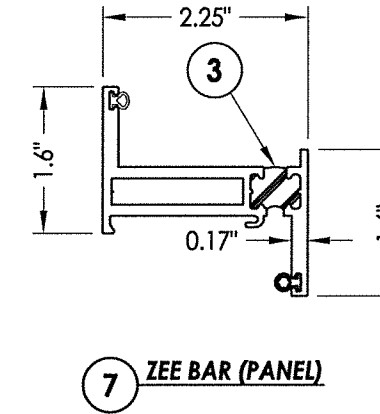
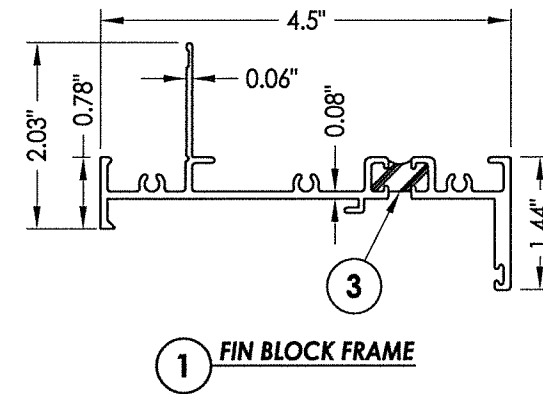
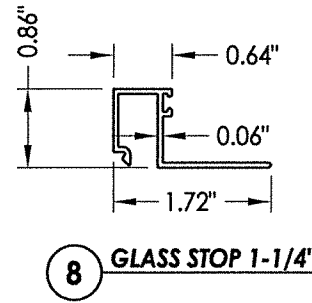
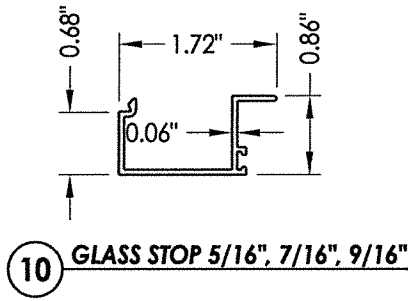
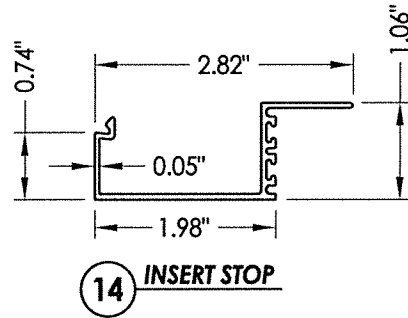
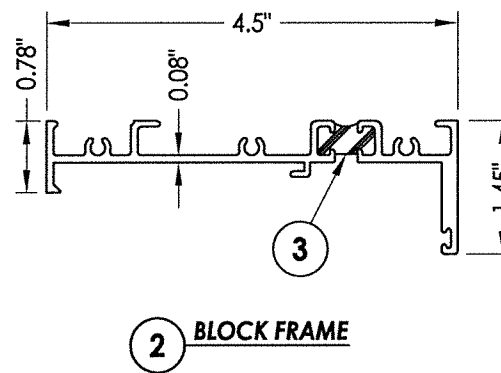

December 8, 2021
 Documents Prepared By:
 Lyndon F. Schmidt
 P.E. No. 43409

R.W.
 BUILDING CONSULTANTS, INC.
 P.O. Box 230, Vairico, FL 33595
 Phone No.: 813.659.9197
 FBPE Registry No. 9813

PRODUCT:		FLEETWOOD WINDOWS AND DOORS	
PART OR ASSEMBLY:		BILL OF MATERIALS AND COMPONENTS	
LFS	DAC	LFS	JK
6	12/08/21	6	12/08/21
5	8/10/20	5	8/10/20
4	8/07/17	4	8/07/17
3	8/22/16	3	8/22/16
2	1/22/15	2	1/22/15
1	4/24/14	1	4/24/14
NO.	DATE	NO.	DATE
REVISIONS			
DATE: 10/23/13			
SCALE: N.T.S.			
DWG. BY: JK			
CHK. BY: LFS			
DRAWING NO.: FL-14907.3			
SHEET 8 OF 8			