

CUSTOMER:	ORDER NO.:
SERIES:	ITEM NO.:

The following Plan View illustration demonstrates the Exterior Rough Opening line between the 2 corner legs on the 135 degree Corner Window.
 Notice, that if you typically use 1/4" as a Shim space at the Jamb, you will now need to refer to the Chart below (based on Series) to add for additional Shim requirements. (This allows the window to be Installed from the Exterior, allowing the frame to rotate into the Opening at the Short Leg Nail-fin Point.
Note: Block frame windows can be Installed from the Interior and will not need the extra Shim.

PLAN VIEW
SERIES 3800-T SHOWN

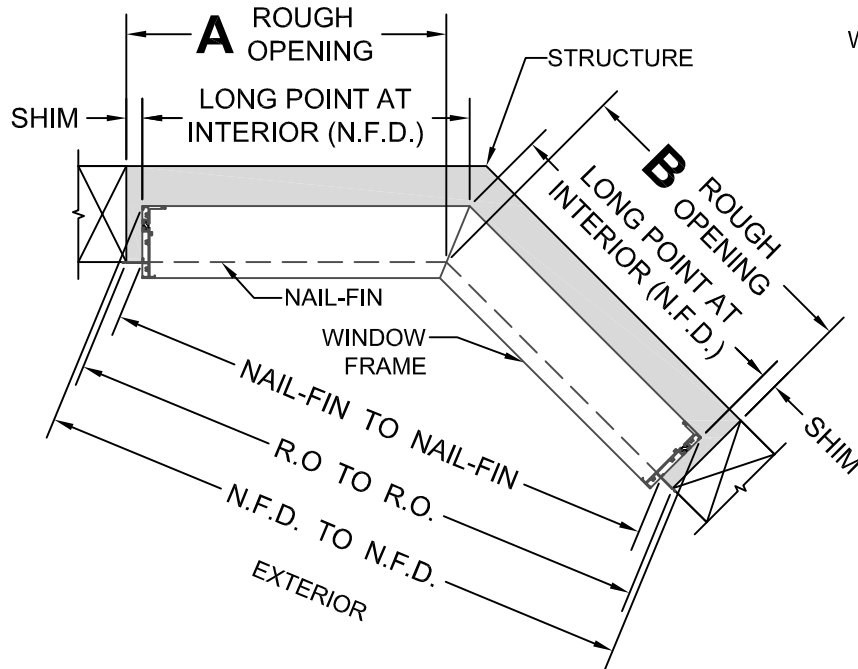

ISOMETRIC VIEW
135 DEGREE INSIDE CORNER

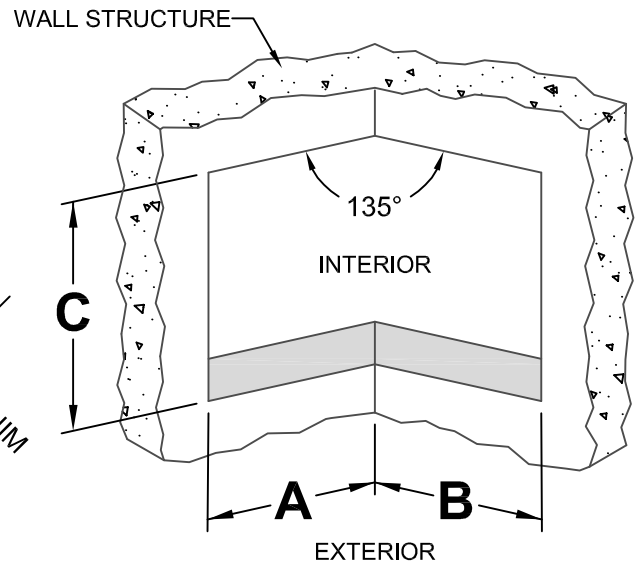

†IMPORTANT: 450-T SHIM SPACE VARIES

INSTRUCTIONS: ENTER THE (3) RO (ROUGH OPENING) DIMENSIONS IN THE TABLE AND CALCULATE REQUIRED N.F.D. BELOW. ENTER BUILDING EXTERIOR DIMENSIONS ONLY!				MINIMUM R.O. SHIM AND *SERIES ADD		
DIM. REF.	CUSTOMER R.O.	*SERIES ADD AND (C) SHIM DEDUCT	LONG POINT (INT.) N.F.D.	SERIES	REQ'D SHIM	*SERIES ADD
A		+ *	=	250-T	.375	.125
B		+ *	=	450-T	.625	.1875
C		- .50 [†]	=	530-T	.75	.25
				3800-T	1.00	.4375
				4800-T	1.375	.5625

CUSTOMER SIGNATURE:	DATE:
---------------------	-------